

ALUMINIUM DIE CAST ENCLOSURES

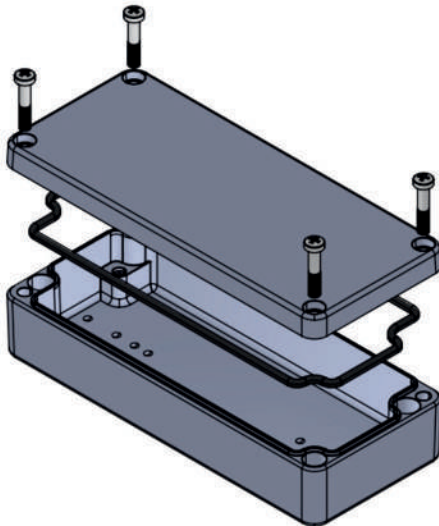

DETAILS	SPECIFICATIONS
DIMENSIONS:	Width (mm) : 64 Length (mm) : 150 Height (mm) : 34
WEIGHT:	274.00 Grams
MATERIAL:	Corrosion Resistant Aluminium Alloy EN AC - AlSi12(Fe) DIN 1706
COLOUR OPTIONS:	Natural Finish Powder Coated Silver Grey RAL 7001 Powder Coated Black RAL 9005 Special Colours available upon request.
PROTECTION CLASS:	IP66, IP67, IP68 & IP69K
PROTECTION AS PER NORM:	IS/EN 60529:2001 - DIN EN60529
GASKET OPTIONS:	Neoprene (Chloroprene) : - 40°C to +130°C Silicon : - 60°C to + 200°C EMI/RFI resistant shielded gaskets on special request.
GASKET TYPE:	One piece compression moulded.
IMPACT RESISTANCE:	Upto 7 Joules, without impairment of Ingress Protection
IMPACT RESISTANCE NORM:	IS/IEC 60079-0:2017 EN 60079
LID MOUNTING SCREWS:	Stainless Steel - SS304 / A2
MOUNTING SCREW SIZE:	M4 X 20, Half Thread
SCREW TIGHTENING TORQUE:	Maximum : 1.5 Nm
SCREW HEAD OPTIONS:	Pan Combi, Cheese, Torx, Allen. Any other types upon special request
EARTH SCREWS:	Copper Coated Steel with integral spring washer
MARKING:	CE - conformité européenne.
ENVIRONMENTAL COMPLIANCE:	ROHS - as per Commission Regulation (EU) No.65/2011 REACH - as per Candidate List Promulgated by ECHA Article 57 of EC 1907/2006
CUSTOMIZATION:	Can be machined to customer requirements. Can be made in special colours.

STANDARD ENCLOSURE KIT CONSISTS

Lid + Base + Gasket + Mounting Screws + Earth Screws



www.bboxenclosures.com

enquiry@bboxenclosures.com

+91 9820012796

MANUFACTURED BY :
DEMO
CASTERS